

RIGID LINE COMPONENTS 3 1/8" SMS

- Außenleitersystem Aluminium/Aluminiumlegierung
- einfache und schnelle Montage
- keine Spezialwerkzeuge erforderlich
- PTFE-Isolation
- für Innenraummontage
- outer conductor system aluminium/aluminium alloy
- quick and simple assembly
- no special tools required
- PTFE insulation
- for indoor application

| Bauteil Part | Bestell-Nummer Part number | |
|-------------------------------------|-------------------------------|-------------|
| Innenleiterrohr (Kupfer) | L = 2 m | BN A0 24 15 |
| Inner conductor tube (copper) | L = 4 m | BN K2 27 70 |
| Außenleiterrohr (Aluminium) | L = 2 m | BN A0 24 17 |
| Outer conductor tube (aluminium) | L = 4 m | BN K2 02 02 |
| Mittelstütze | | BN 53 27 22 |
| Inner support | | |
| Übergang SMS Schelle auf 3 1/8" EIA | | BN 53 27 24 |
| Adaptor SMS clamp to 3 1/8" EIA | | |
| Kupplungselement | | BN 53 27 21 |
| Coupling element | | |
| 90° Winkel | | BN 53 27 23 |
| 90° Elbow | | |

| | | |
|---|-----------------|------------------------------------|
| Wellenwiderstand Impedance | 50 Ω | |
| Grenzfrequenz für H ₁₁ -Mode Cut off frequency for H ₁₁ mode | 1.6 GHz | Luftdielektrikum Air dielectric |
| Spannungsfestigkeit in Meereshöhe Proof voltage at sea level | 14.0 kV | 50...60 Hz |
| Arbeitsspannung in Meereshöhe Working voltage at sea level | 9.5 kV | 50...60 Hz |
| Frequenzbereich Frequency range | 0 ≤ f ≤ 1.3 GHz | |
| Effektive Leistung* Average power* | 100 MHz | ≤ 63.0 kW |
| | 230 MHz | ≤ 42.0 kW |
| | 860 MHz | ≤ 22.0 kW |
| Dämpfung** Attenuation** (dB/100 m) | 100 MHz | 0.37 |
| | 230 MHz | 0.56 |
| | 860 MHz | 1.08 |

* bei + 40 °C Umgebungstemperatur und + 80 °C Oberflächentemperatur am Außenleiter
at + 40 °C ambient temperature and + 80 °C surface temperature of the outer conductor

** bei + 20 °C Umgebungstemperatur
at + 20 °C ambient temperature

RIGID LINE COMPONENTS 3 1/8" SMS

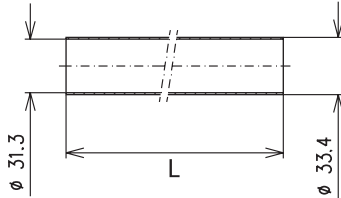

Innenleiterrohr
Inner conductor tube
BN A0 24 15, BN K2 27 70

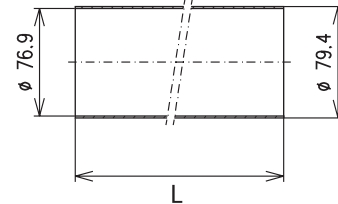

Außenleiterrohr
Outer conductor tube
BN A0 24 17, BN K2 02 02

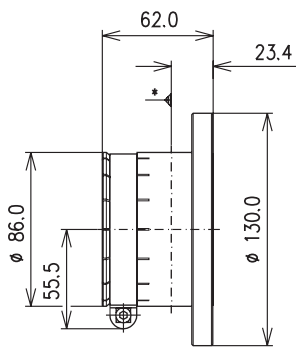

Übergang SMS Schelle auf 3 1/8" EIA
Adaptor SMS clamp to 3 1/8" EIA
BN 53 27 24

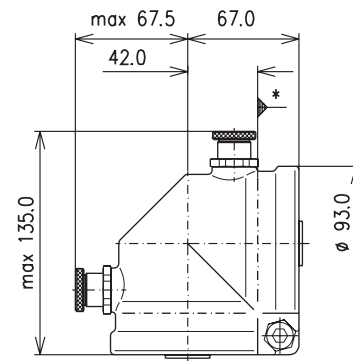

90° Winkel
90° Elbow
BN 53 27 23

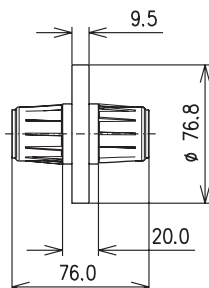

Mittelstütze
Inner support
BN 53 27 22

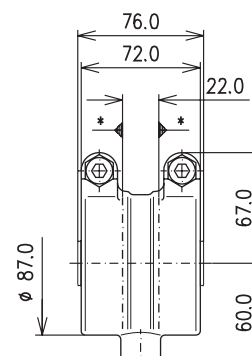

Kupplungselement
Coupling element
BN 53 27 21

| Rohrleitungslänge L Length of rigid line L | benötigte Anzahl der Mittelstützen number inner supports required |
|---|--|
| 2.0 m ≤ L ≤ 4.0 m | 1 |