

4 3 2 1

REVISIONS			
REV.	DESCRIPTION	DATE	APPROVED
A	INITIAL RELEASE	11/22/22	J. QU

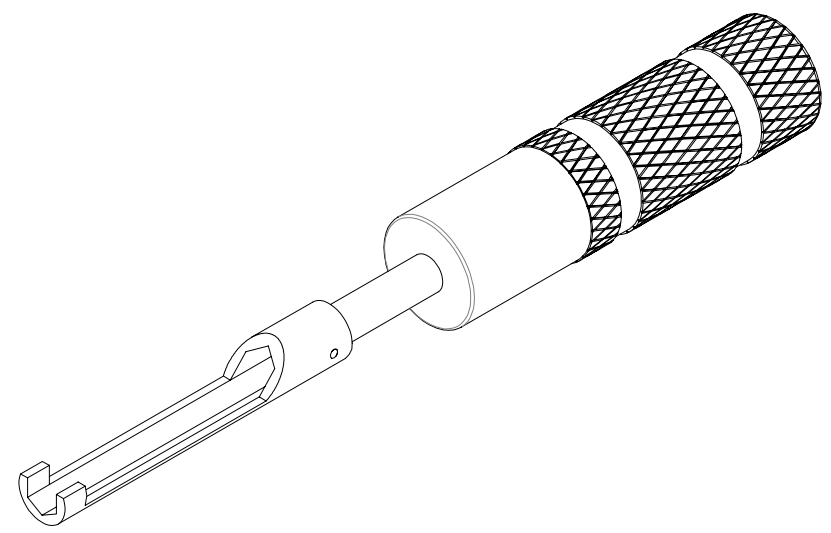
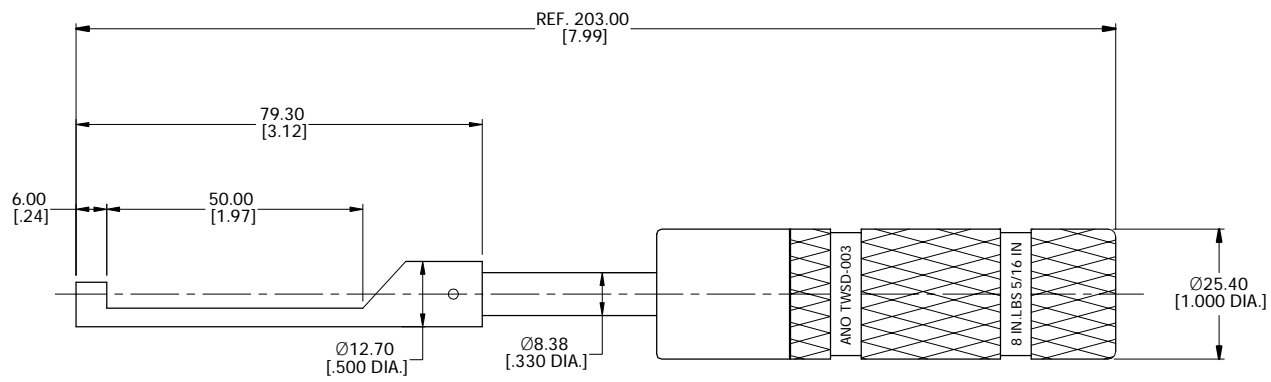

- 1. TORQUE VALUE: 0.9±0.04 NM [8±0.32 IN.LBS]
- 2. SIZE: 8.0 MM [5/16 IN.]

D
C
B
A

D
C
B
A

4 3 2 1

DRAWN	X. Y	DATE	11/22/22
CHECKED	W. Y	DATE	11/22/22
APPROVED	J. Q	DATE	11/22/22
UNLESS OTHERWISE SPECIFIED DIMENSIONS ARE IN MILLIMETERS, DIMENSIONS IN [] ARE IN INCHES FOR CUSTOMER REFERENCE ONLY UNLESS OTHERWISE SPECIFIED TOLERANCE ARE:		THESE DRAWINGS AND SPECIFICATIONS ARE THE PROPERTY OF ANOISON ELECTRONICS LTD AND SHOULD NOT BE USED WITHOUT WRITTEN PERMISSION COPYRIGHT © 2022 ANOISON ELECTRONICS LTD	
XX	±0.13 [.005"]		
X	±0.20 [.008"]		
X	±0.50 [.019"]		
X°	±1°		
X"	±2°		



TITLE TORQUE WRENCH IN SCREWDRIVER TYPE FOR SMA/3.5 MM/2.92 MM/2.4 MM/1.85 MM TYPE CONNECTORS PRESET TORQUE= 0.9±0.04 NM [8±0.32 IN.LBS] HEX SIZE 8.0 MM [5/16 IN.]

VIEW	PART NO. ANO TWS D-003		
	SIZE A3	SCALE 5:1	SHEET 1/1 REV. A