

Model GKTSX-2-XX-X-A2 DC-6GHz 2,10 Watts

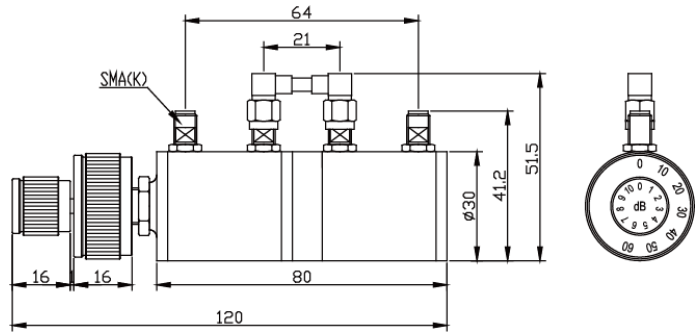

Rotary Step attenuators are used to adjust the power signal level by step within certain frequency range without power off, they can also be used to adjust the test system's power level as inset attenuators, it is small with high accuracy and high stability etc.

GKTS serial A2 type rotary step attenuators' average power is 2W, 10W, frequency range from DC-6GHz, attenuation value 0-100dB by 0.1dB/ 1dB step.

MECHANICAL SPECIFICATIONS	
Connectors	Brass Nickel Plated
Female Pin	Beryllium Copper Gold Plated
Housing	Brass Silver Plated
Temp Range	-20°C~+85°C
Dimensions	Ø30×120mm(Without Connector)
Weight	435g

RoHS Compliant: Yes

ELECTRICAL SPECIFICATIONS

Model Number	Frequency Range(GHz)	Attenuation Step Size	Max VSWR		Insertion Loss(dB)	Attenuation Accuracy(dB)
			SMA	N		
GKTSX-2-11-2.5-A2	DC-2.5	0-11dB in 0.1dB steps	1.30	1.45	≤1.0	±0.2dB(≤1dB) ±0.4dB(>1dB)
GKTSX-2-11-3-A2	DC-3		1.35	1.45	≤1.2	±0.3dB(≤1dB) ±0.5dB(>1dB)
GKTSX-2-11-4.3-A2	DC-4.3		1.40	1.55	≤1.5	
GKTSX-2-11-6-A2	DC-6		1.55	1.60	≤1.8	
GKTSX-2-50-2.5-A2	DC-2.5	0-50dB in 1dB steps	1.30	1.35	≤1.0	±0.5dB(≤10dB) ±0.8dB or 3% (≤50dB)
GKTSX-2-70-2.5-A2	DC-2.5	0-70dB in 1dB steps	1.30	1.45	≤1.0	±0.5dB(≤10dB) ±0.8dB or 3% (<60dB) ±1.5dB or 3% (≥60dB)
GKTSX-2-70-3-A2	DC-3		1.35	1.45	≤1.2	
GKTSX-2-70-4.3-A2	DC-4.3		1.40	1.55	≤1.5	
GKTSX-2-70-6-A2	DC-6		1.55	1.60	≤1.8	
GKTSX-2-100-2.5-A2	DC-2.5	0-100dB in 1dB steps	1.30	1.45	≤1.0	±0.5dB(≤10dB) ±0.8dB or 3% (<60dB) ±1.5dB or 3% (<70dB) ±3.5% (≥70dB)
GKTSX-2-100-3-A2	DC-3		1.35	1.45	≤1.2	

NOMINAL IMPEDANCE: 50Ω

AVERAGE POWER: 2W,10W

PEAK POWER: 100W (5μs pulse width with 2% duty cycle)

CONNECTOR TYPE: SMA (F,F); N(F,F)

Notes:

1. Dimensions Tolerance ±2%
2. Custom designs available for other special attenuation value & accuracy