



Load, N male, 2Watt

Product Description

The N-TER series are medium power coaxial loads, which operate from DC up to 3.0GHz.



sample is N-TER-02

Features/Benefits

- Low VSWR
- RoHS compliant
- Designed for wireless applications

Technical Specifications

Product Type	Load
Techn. Application	Indoor
Frequency Range, MHz	DC-3.000
Input Connector Type	N male
Impedance, Ohm	50
Max. VSWR / Return Loss, dB	1.2 / 20.8
Total Input Power, W	2
Temperature Range, °C (°F)	-40 to 65 (-40 to 149)
Height, mm (in)	32 (1.26)
Diameter, mm (in)	21 (0.83)
Environmental Class	IP54

Notes

Other Documentation

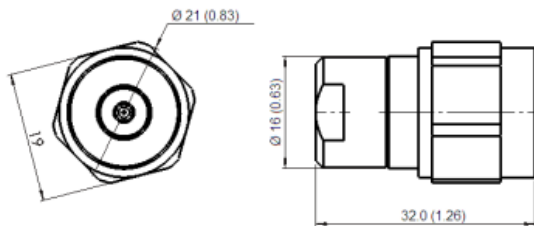

N-TER-01_02 sketch

All information contained in the present datasheet is subject to confirmation at time of ordering