



BOOT-CP-12

Cushion plug for 1/2" feed through assemblies

Cushion inserts for 1/2" boot assemblies

FEATURES / BENEFITS

Cushion plug for unused holes in a boot entry. The plug is removable and allows a future expansion.

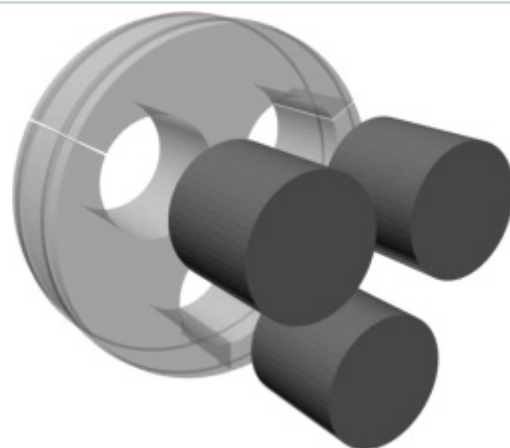

Technical features

STRUCTURE

Product Line		Coaxial Cable Accessories
Product Type		Wall/Roof Feed-Through System
Feed-Through Component		Boot Assembly
Transmission Line Type		LCF12, HCA12-50
Coaxial Cable Type		Foam Dielectric
Cable Size		1/2"

MECHANICAL SPECIFICATIONS

Mated to Cable Size and Interface		1/2
Color		Black
Material		EPDM rubber

TEMPERATURE SPECIFICATIONS

Operation Temperature, °C(°F)	°C(°F)	-50 to 85 (-58 to 185)
Storage Temperature	°C(°F)	-50 to 85 (-58 to 185)

PACKAGING INFORMATION

Package Quantity		5
------------------	--	---

External Document Links

Notes